

P/N 11205852B
BRUSH ASSEMBLY
W/O TEE (5)

POWER - PREWIRED AT
FACTORY TO CERLIC CONTROL
BOX OR SUPPLIED WITH 20'
OF LEAD TO ATTACH TO
CERLIC CONTROL BOX

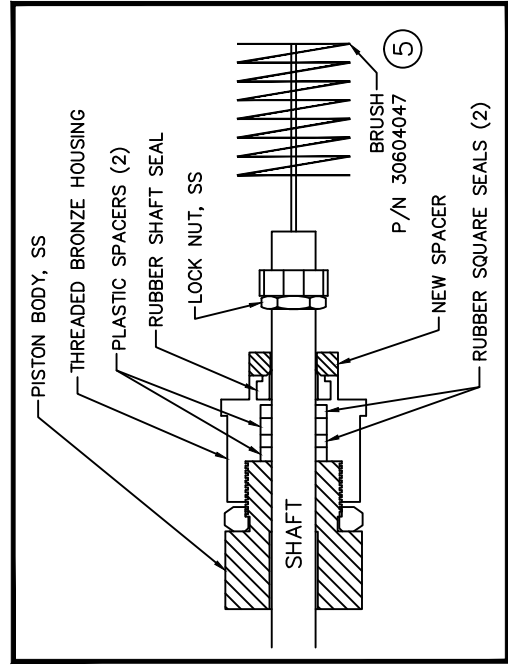
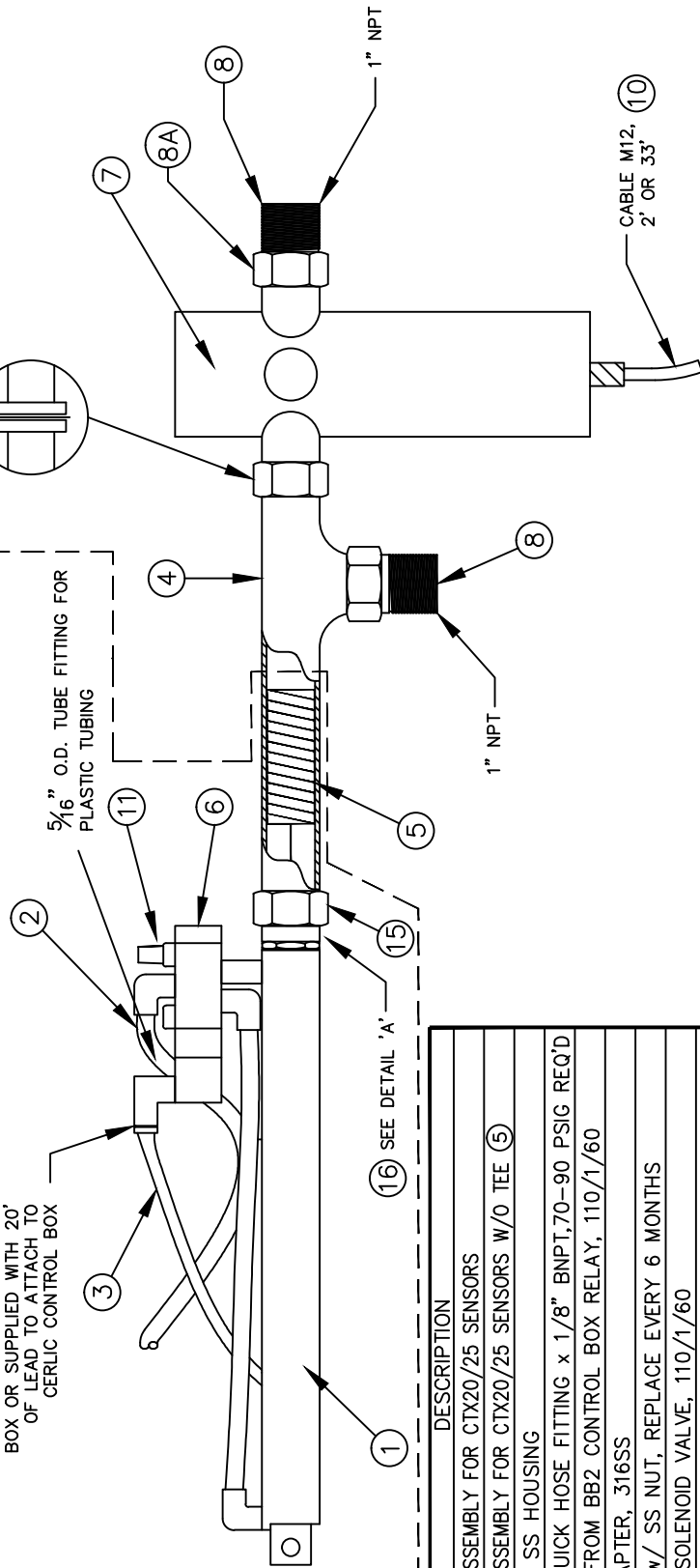

DETAIL 'A'
NEW MECHANICAL
SEAL ASSEMBLY
P/N 10306020 (16)

NO.	P/N	DESCRIPTION
	11203178B	BRUSH ASSEMBLY FOR CTX20/25 SENSORS
	11205852B	BRUSH ASSEMBLY FOR CTX20/25 SENSORS W/O TEE (5)
1	31704026	PISTON, SS HOUSING
2		5/16" QUICK HOSE FITTING x 1/8" BNPT, 70-90 PSIG REQ'D
3		POWER FROM BB2 CONTROL BOX RELAY, 110/1/60
4		TEE ADAPTER, 316SS
5	30604047	BRUSH w/ SS NUT, REPLACE EVERY 6 MONTHS
6	31704027	4-WAY SOLENOID VALVE, 110/1/60
7	11305503	CTX20/25 SENSOR, VITON O-RINGS
	11305531	CTX20/25LC, LOW SOLIDS SENSOR
	11305707	CTX20/25K SENSOR, KALREZ O-RINGS
8	311404016	1" NPT x METRIC COUPLING WITH NUT, 316SS
8A	10303355	NUT, 316SS, METRIC
9	21603365	GASKET FOR 25 mm FITTING, TEFLON
10	30804063	CABLE, 2' LONG, M12 CONNECTIONS
	20805510	CABLE, 33' LONG, M12 CONNECTIONS
11		MUFFLER, BRASS, 1/8" BNPT
12	10303182	THREADED COLLAR FOR PISTON, 316SS
13	21150224	RETAINER WASHER, 316SS, M10
14		O-RING, VITON, 9.3 mm x 2.4 mm
15	10303355	NUT, 316SS, COLLAR TO TEE
16	10306020	NEW S.S. MECHANICAL SEAL ASSEMBLY

ASSEMBLY DRAWING FOR CTX20/25 SENSOR W/ AUTOMATIC BRUSH ASSEMBLY		JLT DRAWN BY (07/25/01)
DRAWING NUMBER 105	LAST REV. DATE 9/2/14	CHECKED BY
	SCALE 1/4	APPROVED BY

Cerlic Environmental Controls, Inc
P.O. Box 420097
Atlanta, GA 30342
Phone (404) 256-3097
Fax (404) 256-3094

